

Service Tech Update

Wilson Elements is pleased to announce the introduction of our new universal element designed to suit a wide range of European manufactured ovens. Utilizing a new & exclusive Wilson Elements designed, innovative mounting plate that has been developed to offer the trade maximum installation flexibility. So you can fix more in less time.

New Universal Fan Oven— Euro

FE-13 & FE-14 Euro Universal - Long Neck

Using the technologies developed for the FE-06/7 models the Long neck series features the same fitting systems to make installation easy.

Plus our new patent pending Flexible wiring coupling allows easier & safer electrical connections.

FE-13 2200W (2 Turn) Long Neck Euro

For Ilve, Kleenmaid 77x2277

FE-14 2500W (3 Turn) Long Neck Euro

For Ilve, AEG

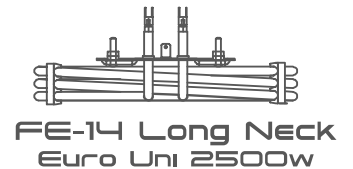
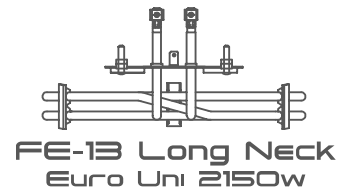
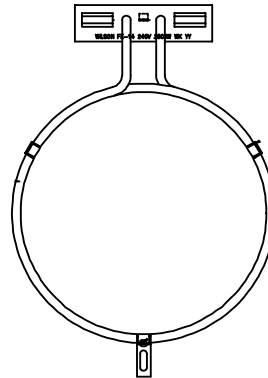

New Connector - A Safer Easier Install

With the introduction of the FE-13 & 14 series, Wilson Elements is also pleased to introduce our new patent pending, flexible connector, which we hope will make for easier fitting by the technician. Designed to accommodate both **double & single quick connect**, as well as bare wire **direct terminate & ringlet** type connections. The quick connect may also be used **in up & down cable orientations** as well as straight out.

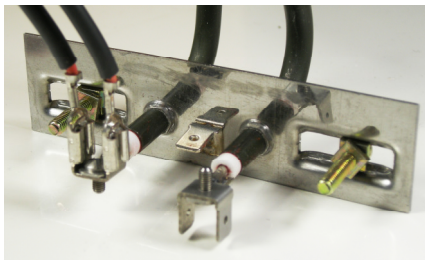

Double Quick Connect

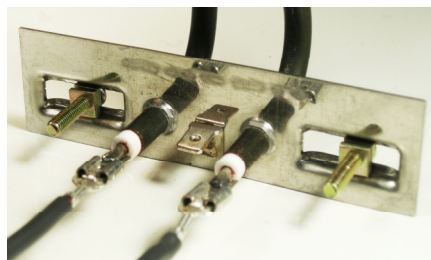

Single Quick Connect

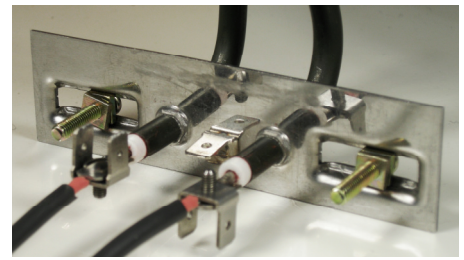

Bare Wire Connection

Other Updates

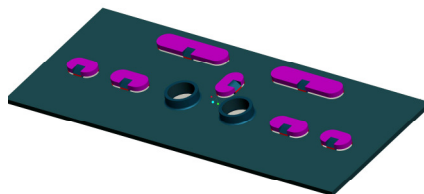

CO-01 & 02 Series. With feedback from the field, the introduction of blanking plates on the multi fit bracket to improve oven thermal isolation as well as new saddle & quick connect termination.

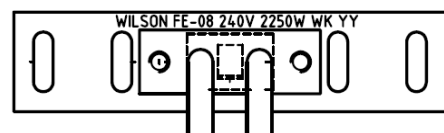

FE-08 Series. New low profile plate. Building on the innovations of the FE-08 design. We have introduced a new low profile bracket which will be included free in the FE-08 service pack as stock becomes available.